

GVS



*Protecting you for
life's best moments.*

Positive pressure loose-fitting respiratory protection



BLASTLINE



The T-Link[®] is a versatile powered or supplied air loose-fitting respirator that provides respiratory protection for a range of industrial applications. Depending on assembly configuration, the T-Link provides certified eye, face, head, and hearing protection.



T-Link Headtops for Powered Air (PX5[®] PAPR)

Part #	Description	Certifications
CORE RANGE 17-110-12-CE	 T-Link Respirator, Bump Cap - Tychem [®] 2000 Hood Package also includes: ■ PX5 breathing tube.	EN12941 3B EN812 EN166
17-000-12-CE	 T-Link Respirator, Hard Hat - Tychem [®] 2000 Hood	EN12941 3B EN166
17-100-12-CE	 T-Link Respirator, Bump Cap - Tychem [®] 2000 Hood	EN12941 3B EN812 EN166

T-Link Headtops for Supplied (Compressed) Air

Part #	Description	Certifications
CORE RANGE 17-120-12	 T-Link SAR Respirator, Bump Cap - Tychem [®] 2000 Hood Package also includes: ■ Low flow indicator ■ SAR breathing tube. - flow device sold separately - page 49.	EN14594 3B EN812 EN166
17-020-12	 T-Link SAR Respirator, Hard Hat - Tychem [®] 2000 Hood Package also includes: ■ Low flow indicator ■ SAR breathing tube. - flow device sold separately - page 49.	EN14594 B3 EN397 EN166

T-Link Accessories

Part #	Description	Certifications
CORE RANGE		
04-852	Tychem [®] Breathing Tube Cover - breathing tube not included.	
04-856	Disposable/Decon Breathing Tube Sleeve (pk 10) - breathing tube not included.	
04-872	Short Tychem [®] Breathing Tube Cover - for backpack assembly, breathing tube not included.	
16-520-S	Comfort-Fit Side Padding System	
16-901	Vision-Link [®] Helmet Light Kit* - includes 09-510-RAW, 16-918 and 15-839.	
16-922	Comms-Link [®] In-Helmet Communication System* (Non IS) - includes 16-529 and 09-913. Radio adaptor sold separately - contact RPB for more information.	
18-533	Quiet-Link [®] Helmet Mounted Earmuffs - includes 18-535 suspension bracket.	EN352-3
18-535	Quiet-Link [®] Suspension Brackets	
18-600	RPB [®] Carry Bag	

T-Link Consumables

Part #	Description	Certifications
CORE RANGE		
04-831	PAPR Breathing Tube	
CORE RANGE		
04-841	Short Breathing Tube - for Backpack Assembly.	
CORE RANGE		
16-526	Head Band Brow Pad	
17-712	Tychem [®] 2000 Hood - replacement hood.	
17-713	Tychem [®] 4000 Hood with Sealed Seams - replacement hood.	
17-713-SX	Tychem [®] 4000 Extra Length Hood with Sealed Seams, Safety Lens and Waist Straps - replacement hood.	EN166 1F 3
CORE RANGE		
17-815	Peel-off Lens (pk 25)	
17-817	Clear Vision Cassette Lens (pk 10) - 7 layers.	

T-Link Parts

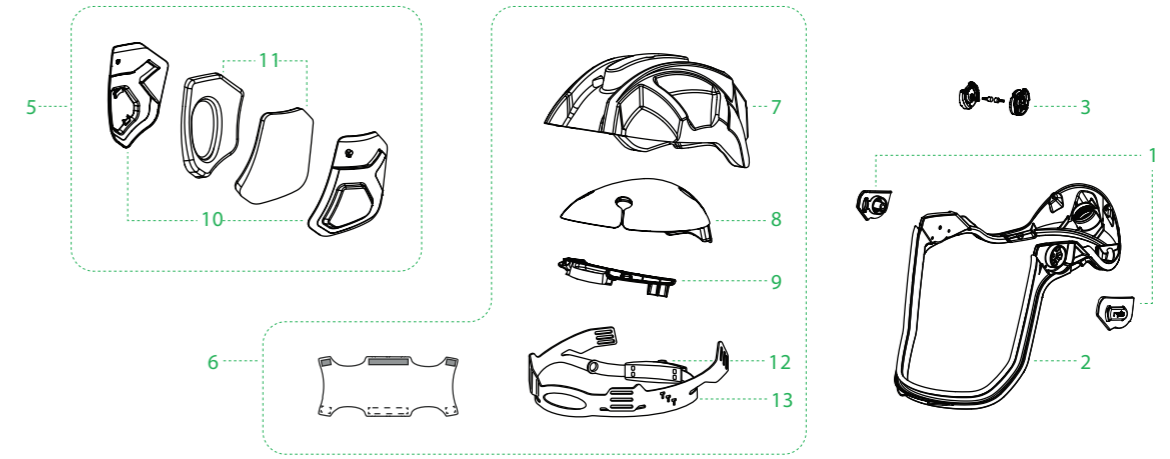









Part # / Description	Part # / Description
1 17-512 Lens Mount Clips - pair.	8 16-522 Comfort Pad
2 16-514 Jaw Assembly - includes screws and 16-515.	9 16-525 Head Harness Bracket and Air Director
3 16-516 Quiet-Link [®] Earmuff Bracket - pair, includes screws.	10 16-527 Comfort-Fit Side Padding Frames
- 16-519 Air Inlet Adapter	11 16-528 Comfort Fit Foam Pads - pair.
5 16-520-S Comfort-Fit Side Padding System	12 16-530 Head Harness Ratchet Assembly
6 16-520-T Fit System	13 16-531 Head Harness Assembly - includes 16-530.
7 16-521 Impact Absorber	- 16-930 Low Flow Indicator
	- 17-110 Bump Cap Assembly



The T200[™] is a lightweight respirator designed for healthcare and life science applications. When used with powered air, the T200 provides respiratory, eye, and face protection.



T200 Headtops for Powered Air (PX5[™] PAPR)

Part #	Description	Certifications
CORE RANGE 17-200-22-CE	 T200 Respirator, Head Harness - Tychem [™] 2000 Face Seal Package also includes: ■ Head harness assembly ■ PX5 breathing tube.	EN12941 TH3 EN166 1F 3
CORE RANGE 17-200-32-CE	 T200 Respirator, Head Harness - Tychem [™] 2000 Hood with Face Seal Package also includes: ■ Head harness assembly ■ PX5 breathing tube.	EN12941 TH3 EN166 1F 3
17-202-22-CE	 T200 Respirator, Head Harness - Tychem [™] 2000 Face Seal Package also includes: ■ Head harness assembly.	EN12941 TH3 EN166 1F 3
17-202-32-CE	 T200 Respirator, Head Harness - Tychem [™] 2000 Hood with Face Seal Package also includes: ■ Head harness assembly.	EN12941 TH3 EN166 1F 3
CORE RANGE 17-210-22-CE	 T200 Respirator, Bump Cap - Tychem [™] 2000 Face Seal Package also includes: ■ Bump Cap assembly ■ PX5 breathing tube.	EN12941 TH3 EN166 1F 3 EN812
17-210-32-CE	 T200 Respirator, Bump Cap - Tychem [™] 2000 Hood with Face Seal Package also includes: ■ Bump Cap assembly ■ PX5 breathing tube.	EN12941 TH3 EN166 1F 3 EN812
17-212-22-CE	 T200 Respirator, Bump Cap - Tychem [™] 2000 Face Seal Package also includes: ■ Bump cap assembly.	EN12941 TH3 EN166 1F 3 EN812
17-212-32-CE	 T200 Respirator, Bump Cap - Tychem [™] 2000 Hood with Face Seal Package also includes: ■ Bump cap assembly.	EN12941 TH3 EN166 1F 3 EN812

T200 Headtops with Powered Air (PX5[™] PAPR)

Part #	Description	Certifications
CORE RANGE 17-0106	 T200 Respirator, Bump Cap - Tychem [™] 2000 Face Seal with PX5 [™] PAPR Package also includes: ■ Head harness assembly ■ Bump Cap ■ PX5 PAPR assembly.	EN12941 TH3 EN166 1F 3 EN812

T200 Accessories

Part #	Description	Certifications
CORE RANGE 04-852	Tychem [®] Breathing Tube Cover - breathing tube not included.	
04-856	Disposable/Decon Breathing Tube Sleeve (pk 10) - breathing tube not included.	
04-872	Short Tychem [®] Breathing Tube Cover - for backpack assembly, breathing tube not included.	
15-850	Bump Cap - includes Comfort and Brow Pad and Front Strap.	
15-855	Bump Cap - includes Comfort Pad.	
18-524	Slim-Line Ear Defenders	EN352-1
18-600	RPB [®] Carry Bag	

T200 Consumables

Part #	Description	Certifications
CORE RANGE 04-831	PAPR Breathing Tube	
CORE RANGE 04-833	Breathing Tube	
CORE RANGE 04-841	Short Breathing Tube - for Backpack Assembly.	
CORE RANGE 16-526	Head Band Brow Pad	
17-712	Tychem [®] 2000 Hood with Neck Seal - replacement hood.	
17-713	Tychem [®] 4000 Hood with Sealed Seams - replacement hood.	
CORE RANGE 17-722	Tychem [®] 2000 Face Seal - replacement hood.	EN166 1F 3
CORE RANGE 17-732	Tychem [®] 2000 Hood with Face Seal - replacement hood.	EN166 1F 3
17-811	Clear Vision Cassette Lens (pk 10) - 7 layers, for face seal hoods.	
CORE RANGE 17-815	Tear-off Lens (pk 25) - for full length hoods.	

T200 Parts

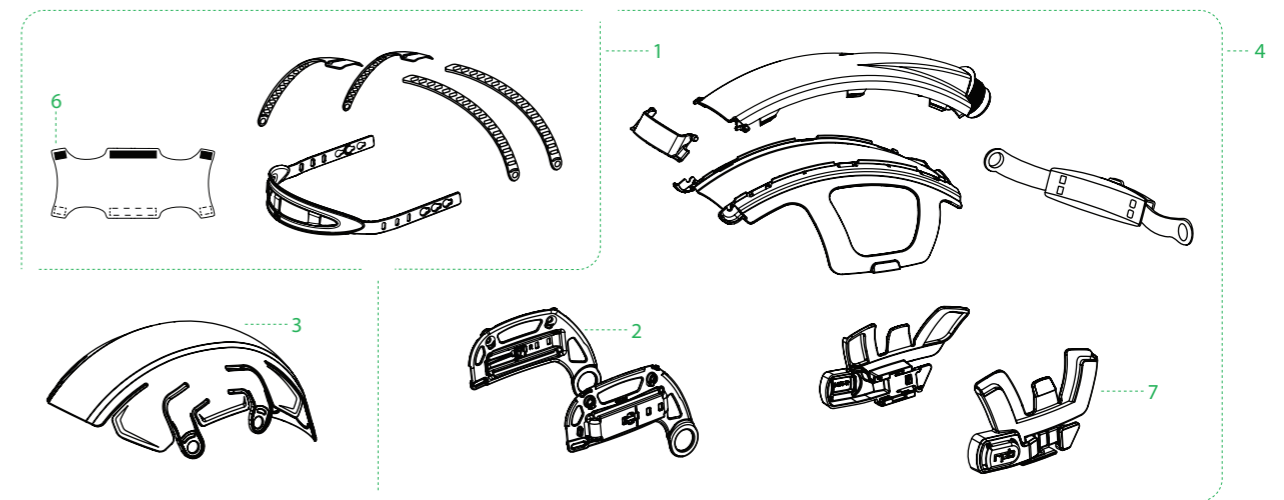

Part # / Description	Part # / Description
1 15-841 Head Harness Assembly	4 15-870 Head Harness Assembly with Air Duct and Lens Mount Clips
2 15-842 Harness Mount - pair.	5 16-530 Head Harness Ratchet Assembly
3 15-850 Bump Cap - includes Comfort and Brow Pad and Front Strap.	CORE RANGE 6 16-526 Head Band Brow Pad
- 15-855 Bump Cap - includes Comfort Pad.	7 17-513 Lens Mounts - pair.

We are the respiratory protection specialists, dedicated to protecting people for life's best moments.

Protecting people drives everything we do at GVS-RPB®. For over four decades, we have serviced the industrial market, working with world leading engineers, constantly pushing creative boundaries with new technology that advances our functional capabilities, seeking input from our end users, and refining our range to create the world's best respirators.

As our passion for protecting people continues to grow, we have extended our product range and branched into new industries, sharing our respiratory protection expertise to better the lives of more people. Through this growth, we have taken the next step in our journey, becoming part of the GVS Group, a global manufacturer of filtration devices for the Medical & Life Science, Energy & Mobility, and Health & Safety industries. By teaming up with dedicated filtration specialists, this enables us to expand the possibilities of what personal protection has to offer as we continue to shape the future of respiratory protection.





The PX5 is a portable, battery powered air purifying respirator (PAPR) which draws in contaminated air from the user's immediate vicinity, passing it through internal filters, and supplying the filtered air to an approved loose-fitting respirator headtop.



PX5 PAPR Approved Headtops



Z-Link
Page 15/16

Z4
Page 23

T-Link
Page 29

T200
Page 33

PX5 PAPR Assemblies

Part #	Description	Certifications
CORE RANGE 03-801-EUUK 	PX5 PAPR Easy Clean Starter Pack Package also includes: ■ Rechargeable battery and charging bank ■ Easy clean belt ■ Flow tester ■ 1x HEPA (P3) filter ■ 1x pre-filters (10pk).	EN12941 IP65
CORE RANGE 03-801-FR-EUUK 	PX5 PAPR Industrial Starter Pack Package also includes: ■ Rechargeable battery and charging bank ■ FR belt ■ Flow tester ■ 1x HEPA (P3) filter ■ 1x spark arrestor ■ 1x pre-filters (10pk).	EN12941 IP65
CORE RANGE 03-802-FR-EUUK 	PX5 PAPR Starter Pack for Gas Filters Package also includes: ■ Rechargeable battery and charging bank ■ FR belt ■ Gas filter door ■ Flow tester ■ 1x spark arrestor ■ 1x pre-filters (10pk). Gas filter sold separately - page 10.	EN12941 IP65
03-803-FR-EUUK 	PX5 PAPR Industrial Starter Pack with Back Harnesses Package also includes: ■ Rechargeable battery and charging bank ■ FR belt with backpack assembly ■ Flow tester ■ 1x HEPA (P3) filter ■ 1x spark arrestor ■ 1x pre-filters (10pk).	EN12941 IP65
03-804-FR-EUUK 	PX5 PAPR Starter Pack for Gas Filters with Back Harnesses Package also includes: ■ Rechargeable battery and charging bank ■ FR belt with backpack assembly ■ Gas filter door ■ Flow tester ■ 1x spark arrestor ■ 1x pre-filters (10pk). Gas filter sold separately - page 10.	EN12941 IP65